

# FUSEVIEW™ 150# HIGH TEMPERATURE SIGHT GLASS P/N'S

	MODEL	PRESSURE	SIZE	WETTED FUSEVIEW™ RING (INNER)	FUSEVIEW™ GLASS (WETTED)	FINISH	RETAINER	TEMPERATURE	NON-WETTED FUSEVIEW™ RING (OUTER)
<b>S</b>	<b>7</b>	<b>A</b>			<b>1</b>			<b>H</b>	
	7 = FVH	A = 150 psi	<b>SIZE (VIEW / O.D.)</b> B = 1" (1" / 2") C = 1.5" (1.5" / 3") E = 2" (2.13" / 3.63") F = 2.5" (2.5" / 4") H = 3" (3" / 5") I = 3.5" (3.5" / 5.5") J = 4" (4" / 6") P = 5" (5" / 7.5") R = 6" (6" / 8.38") V = 8" (8" / 10.5")	A = CS C = ALLOY C D = C276 E = C-22®	1 = BORO PLUS™	<b>WETTED (STANDARD = 0)</b> 0 = 32 µin[.81 µm] Ra B = 20 µin[.51 µm] Ra(BPE-SF1) C = 15 µin[.38 µm] Ra L = 20 µin[.51 µm] Ra ELECTROPOLISHED (BPE-SF5) M = 15 µin[.38 µm] Ra ELECTROPOLISHED (BPE-SF4)  <b>NON-WETTED</b> 32 µin[.81 µm] Ra	0 = NF 1 = CS 2 = SS  (SEE NOTE 4)	H = SEE BELOW FOR MATL. / SIZE / TEMP. SPECS.  - CARBON STL., WETTED OR NON WETTED, 1" - 8" SIZES = 450°F - 600°F  - ALLOY C, C276, C-22®, BOTH WETTED & NON WETTED, 1" - 6" SIZES = 450°F - 650°F  - ANY MATERIAL TEAM 8" SIZE = 450°F - 600°F	A = CS C = ALLOY C D = C276  (SEE NOTE 4)

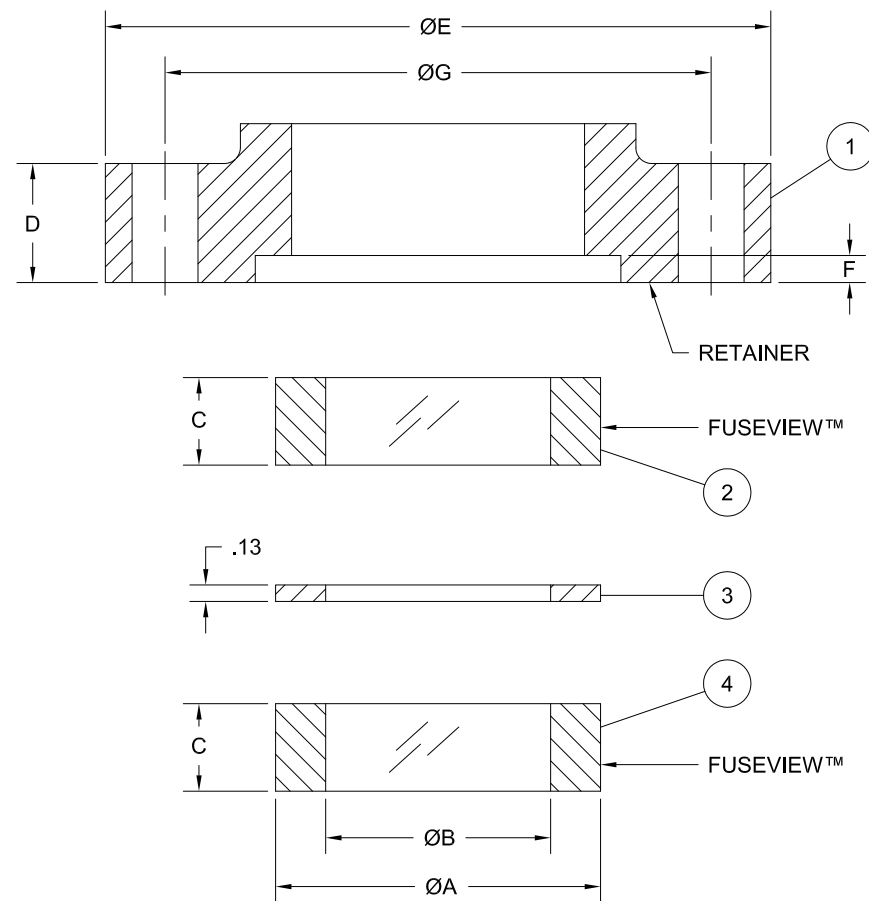

**LEGEND**  
 NF = NO RETAINING FLANGE  
 CS = CARBON STEEL  
 SS = 316L STAINLESS STEEL  
 C276 = HASTELLOY® C276 OR EQUAL  
 C-22® = HASTELLOY® C-22® OR EQUAL

SIZE in.	ØA in.	ØB in.	C in.	D in.	ØE in.	F in.	HOLE PATTERN		
							ØG in.	QTY.	Ø in.
1	2	1.13	.75	.56	4.25	.13	3.13	4	.63
1.5	3	1.5	.75	.69	5	.13	3.88	4	.63
2	3.63	2.13	.75	.75	6	.13	4.75	4	.75
2.5	4	2.5	.75	.88	7	.13	5.5	4	.75
3	5	3	.75	.94	7.5	.13	6	4	.75
3.5	5.5	3.5	.75	.94	8.5	.13	7	8	.75
4	6	4	.75	.94	9	.13	7.5	8	.75
5	7.5	5	.75	.94	10	.13	8.5	8	.88
6	8.38	6	.75	1	11	.13	9.5	8	.88
8	10.5	8	1	1.13	13.5	.13	11.75	8	.88

BILL OF MATERIALS			
ITEM	QTY	DESCRIPTION	MATERIAL
1	1	RETAINING FLANGE	C.S., 316L S.S.
2	1	OUTER FUSEVIEW™	C.S., ALLOY C, HASTELLOY® C276
3	1	GASKET	GRAFOIL®
4	1	INNER FUSEVIEW™	C.S., ALLOY C, HASTELLOY® C276, HASTELLOY® C-22®

**NOTES:**

- CARBON STEEL SIGHT GLASSES ARE NICKEL PLATED.
- ALLOY C ONLY AVAILABLE IN SIZES 3", 4", 5", 6" & 8".
- ALL REGISTERED TRADEMARKS ARE PROPERTY OF THEIR RESPECTIVE OWNERS.
- THE S.S. RETAINER OPTION INCLUDES A C276 OUTER FUSEVIEW FOR 1" THRU 2.5" SIZES AND AN ALLOY C OUTER FUSEVIEW FOR 3" THRU 8" SIZES.
- ALL INFORMATION IS SUBJECT TO CHANGE WITHOUT NOTICE.

**NOTICE**  
 THIS DRAWING IS THE PROPERTY OF J.M. CANTY AND MUST BE RETURNED WITHOUT REPRODUCTION OR DUPLICATION, AT ANY TIME UPON REQUEST, BUT IN ANY EVENT AS SOON AS IT HAS SERVED THE PURPOSE FOR WHICH IT WAS FURNISHED. WHILE IN THE POSSESSION OF THE RECIPIENT, IT MUST BE PROPERLY SAFEGUARDED AGAINST DISCLOSURE TO ANYONE EXCEPT THOSE EMPLOYEES WHO REQUIRE IT FOR WORK OR JOB. THE RECIPIENT MUST KEEP CONFIDENTIAL AND REQUIRE HIS (HER) EMPLOYEES TO KEEP CONFIDENTIAL THE INFORMATION CONTAINED HERE ON.

DRAWN BY <b>CMB</b>	DATE 17-Feb-94
APPROVAL <b>RFM</b>	DATE 17-Feb-94
ENGINEERING ANALYSIS <b>CURRENT</b>	DATE
MFG. APPROVAL <b>PENDING</b>	DATE
QUALITY CONTROL <b>I.O.A.</b>	DATE

J.M. CANTY INC. 6100 DONNER RD. BUFFALO, N.Y. 14094 U.S.A.		<b>CANTY</b> WWW.JMCANTY.COM	J.M. CANTY INTL. LTD. BALLYCOLIN BUS. PK. BLANCHARDSTOWN DUBLIN 15, IRELAND
TITLE <b>FUSEVIEW™ 150# HIGH TEMPERATURE SIGHT GLASS DIMENSIONS &amp; P/N SELECTION - SALES</b>			
SIZE <b>C</b>	REVISION <b>15</b>	FILE NAME <b>94C5059</b>	
SCALE N.T.S.			SHEET 1 OF 1