

FUSEVIEW™ 300# HIGH TEMPERATURE SIGHT GLASS P/N'S

	MODEL	PRESSURE	SIZE	FUSEVIEW™ RING (WETTED)	FUSEVIEW™ GLASS (WETTED)	FINISH	RETAINER	TEMPERATURE	OUTER FUSEVIEW™
S	7	B			1			H	
	7 = FVH	B = 300 psi	SIZE (VIEW / O.D.) B = 1" (1" / 2") C = 1.5" (1.5" / 3") E = 2" (2.13" / 3.63") F = 2.5" (2.5" / 4") H = 3" (3" / 5") I = 3.5" (3.5" / 5.5") J = 4" (4" / 6") R = 6" (6" / 8.38")	A = CS C = ALLOY C D = C276 E = C-22®	1 = BORO PLUS™	WETTED (STANDARD = 0) 0 = 32 µin[.81 µm] Ra B = 20 µin[.51 µm] Ra(BPE-SF1) C = 15 µin[.38 µm] Ra L = 20 µin[.51 µm] Ra ELECTROPOLISHED (BPE-SF5) M = 15 µin[.38 µm] Ra ELECTROPOLISHED (BPE-SF4) NON-WETTED 32 µin[.81 µm] Ra	0 = NF 1 = CS 2 = SS (SEE NOTE 4)	H = 450°F - 600°F	A = CS C = ALLOY C D = C276 (SEE NOTE 4)

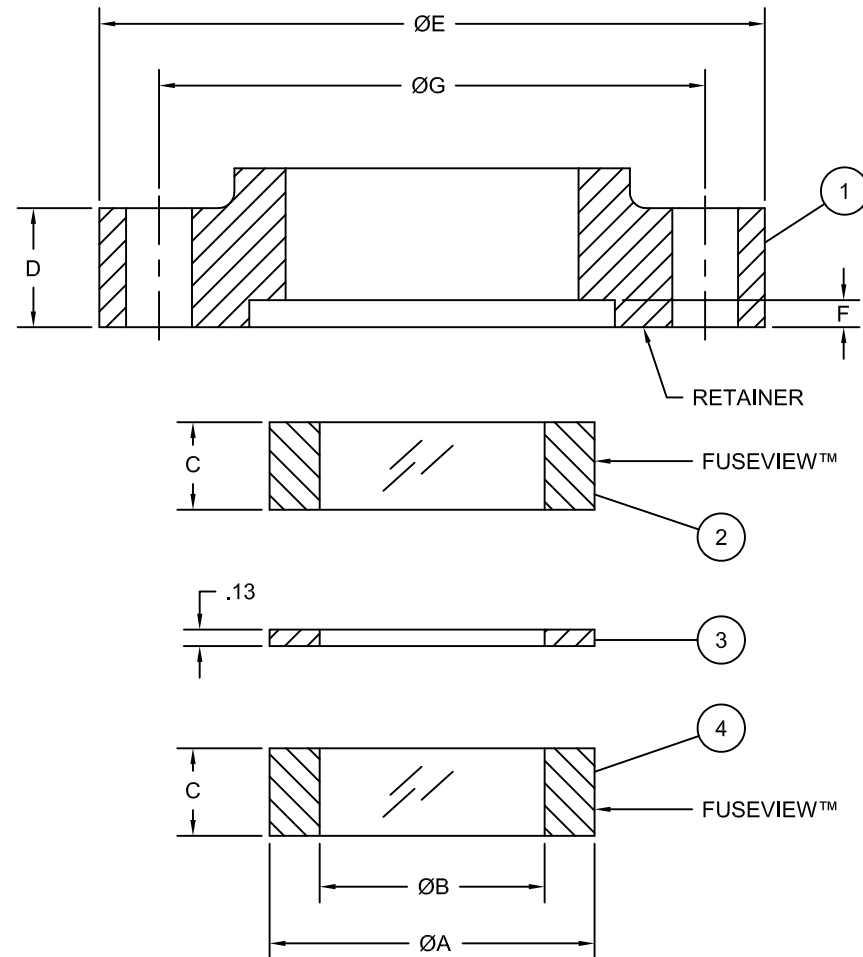

SIZE in.	ØA in.	ØB in.	C in.	D in.	ØE in.	F in.	HOLE PATTERN			PRESSURE RATING psi	TEMPERATURE RATING °F
							ØG in.	QTY.	Ø in.		
1	2	1.13	.75	.68	4.88	.13	3.5	4	.75	300	600
1.5	3	1.5	.75	.81	6.13	.13	4.5	4	.88	300	600
2	3.63	2.13	.75	.88	6.5	.13	5	8	.75	300	600
2.5	4	2.5	.75	1	7.5	.13	5.88	8	.88	300	600
3	5	3	.75	1.13	8.25	.13	6.63	8	.88	300	600
3.5	5.5	3.5	.75	1.19	9	.13	7.25	8	.88	300	600
4	6	4	.9	1.25	10	.13	7.88	8	.88	300	600
6	8.38	6	.9	1.44	12.5	.13	10.63	12	.88	300	600

LEGEND
 NF = NO RETAINING FLANGE
 CS = CARBON STEEL
 SS = 316L STAINLESS STEEL
 C276 = HASTELLOY® C276 OR EQUAL
 C-22® = HASTELLOY® C-22® OR EQUAL

BILL OF MATERIALS			
ITEM	QTY	DESCRIPTION	MATERIAL
1	1	RETAINING FLANGE	C.S., 316L S.S.
2	1	OUTER FUSEVIEW™	C.S., ALLOY C, HASTELLOY® C276
3	1	GASKET	GRAFOIL®
4	1	INNER FUSEVIEW™	C.S., ALLOY C, HASTELLOY® C276, HASTELLOY® C-22®

NOTES:

- CARBON STEEL SIGHT GLASSES ARE NICKEL PLATED.
- ALLOY C ONLY AVAILABLE IN SIZES 3", 4", 5" & 6".
- ALL REGISTERED TRADEMARKS ARE PROPERTY OF THEIR RESPECTIVE OWNERS.
- THE S.S. RETAINER OPTION INCLUDES A C276 OUTER FUSEVIEW FOR 1" THRU 2.5" SIZES AND AN ALLOY C OUTER FUSEVIEW FOR 3" THRU 6" SIZES.
- ALL INFORMATION IS SUBJECT TO CHANGE WITHOUT NOTICE.

<p>NOTICE THIS DRAWING IS THE PROPERTY OF J.M. CANTY AND MUST BE RETURNED WITHOUT REPRODUCTION OR DUPLICATION, AT ANY TIME UPON REQUEST, BUT IN ANY EVENT AS SOON AS IT HAS SERVED THE PURPOSE FOR WHICH IT WAS FURNISHED. WHILE IN THE POSSESSION OF THE RECIPIENT, IT MUST BE PROPERLY SAFEGUARDED AGAINST DISCLOSURE TO ANYONE EXCEPT THOSE EMPLOYEES WHO REQUIRE IT FOR WORK OR JOB. THE RECIPIENT MUST KEEP CONFIDENTIAL AND REQUIRE HIS (HER) EMPLOYEES TO KEEP CONFIDENTIAL THE INFORMATION CONTAINED HERE ON.</p>	DRAWN BY GKW	DATE 11-Jul-94	J.M. CANTY INC. 6100 DONNER RD. BUFFALO, N.Y. 14094 U.S.A.		J.M. CANTY INTL. LTD. BALLYCOLIN BUS. PK. BLANCHARDSTOWN DUBLIN 15, IRELAND
	APPROVAL RFM	DATE 11-Jul-94			
	ENGINEERING ANALYSIS CURRENT	DATE	SIZE C	REVISION 2	FILE NAME 94C5394
	MFG. APPROVAL PENDING	DATE	SCALE N.T.S.	SHEET 1 OF 1	
QUALITY CONTROL I.O.A.	DATE				