

**PROCESS AREA**

**SAFE AREA**

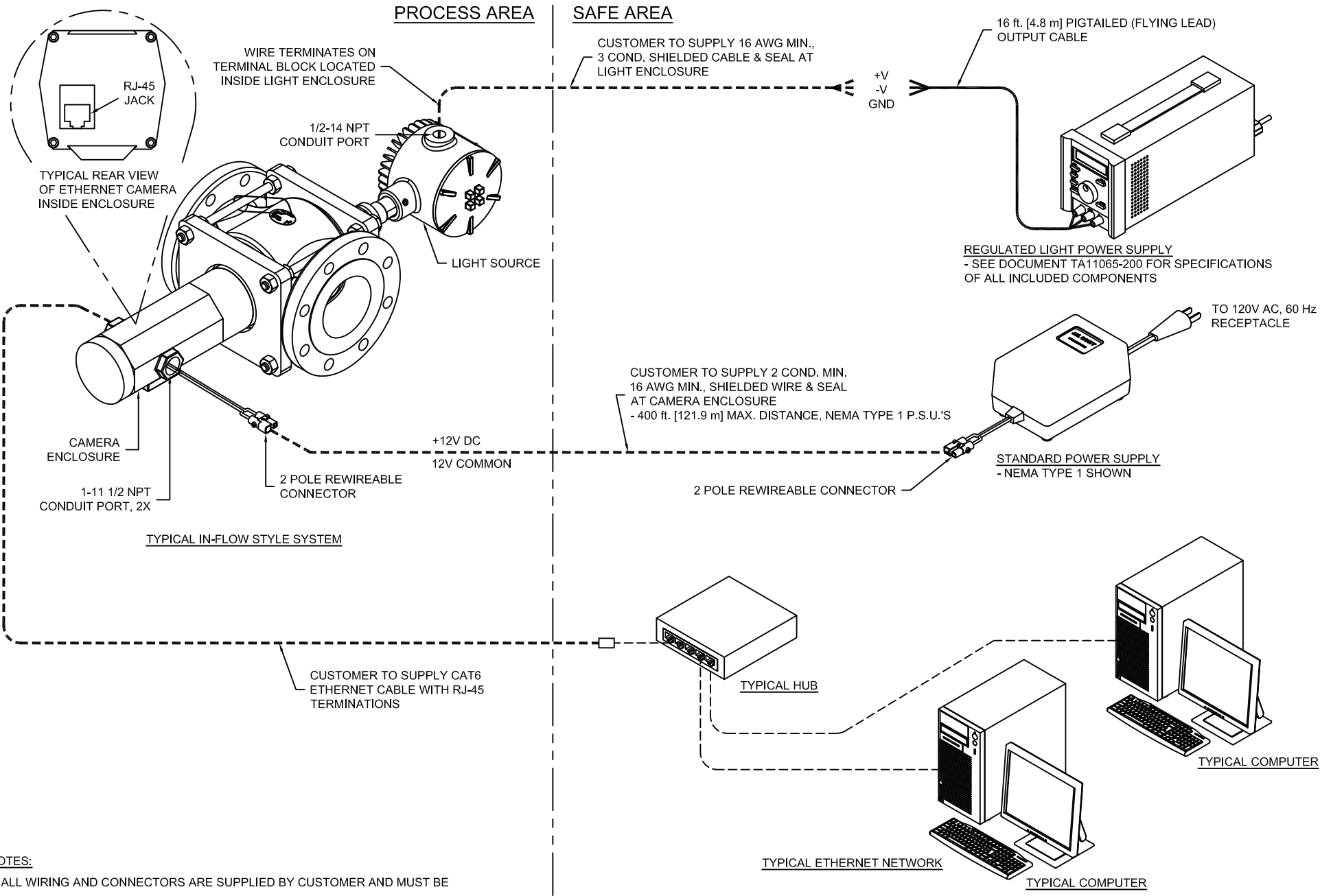

TYPICAL IN-FLOW STYLE SYSTEM

TYPICAL HUB

TYPICAL COMPUTER

TYPICAL ETHERNET NETWORK

TYPICAL COMPUTER

**NOTES:**

1. ALL WIRING AND CONNECTORS ARE SUPPLIED BY CUSTOMER AND MUST BE COMPLETED IN ACCORDANCE WITH APPLICABLE REGULATIONS.
2. ETHERNET CAMERA IS CONNECTED TO CUSTOMER'S DEDICATED ETHERNET NETWORK VIA CAT6 ETHERNET CABLE.
3. EACH ETHERNET VISION SYSTEM IS PROVIDED WITH A 5 - CLIENT LICENSE OF CANTYVISIONCLIENT™ SOFTWARE FOR REMOTE VIEWING ON A CUSTOMER SUPPLIED COMPUTER.
4. REFERENCE DATA SHEETS TA10590-1 AND TA10601-1.
5. ALL INFORMATION SUBJECT TO CHANGE WITHOUT NOTICE.

**NOTICE**  
THIS DRAWING IS THE PROPERTY OF J.M. CANTY AND MUST BE RETURNED WITHOUT REPRODUCTION OR DUPLICATION, AT ANY TIME UPON REQUEST, BUT IN ANY EVENT AS SOON AS IT HAS SERVED THE PURPOSE FOR WHICH IT WAS FURNISHED, WHILE IN THE POSSESSION OF THE RECIPIENT, IT MUST BE PROPERLY SAFEGUARDED AGAINST DISCLOSURE TO ANYONE EXCEPT THOSE EMPLOYEES WHO REQUIRE IT FOR WORK OR JOB. THE RECIPIENT MUST KEEP CONFIDENTIAL AND REQUIRE HIS (HER) EMPLOYEES TO KEEP CONFIDENTIAL THE INFORMATION CONTAINED HERE ON.

**IMPORTANT**  
FOR THE REQUIRED MANUFACTURING SPECIFICATIONS SEE DOCUMENT #A4955  
  
NOTE: FAILURE TO RECEIVE DOCUMENT DOES NOT WAIVE VENDOR RESPONSIBILITY

DRAWN BY GKW	DATE 23-JUL-08
APPROVAL JD	DATE 23-JUL-08
ENGINEERING ANALYSIS CURRENT	DATE
MFG. APPROVAL PENDING	DATE
QUALITY CONTROL I.O.A.	DATE

J.M. CANTY INC. 6100 DONNER RD. BUFFALO, N.Y. 14094 U.S.A.	
<b>CANTY</b> WWW.JMCANTY.COM	
TITLE TYPICAL ETHERNET VISION SYSTEM LAYOUT & WIRING, IN-FLOW STYLE SYSTEMS, CANTY U.	
SIZE C	REVISION 1
FILE NAME C11084	
SCALE NTS	SHEET 1 OF 1

J.M. CANTY INTL. LTD. BALLYCOOLIN BUS. PK. BLANCHARDSTOWN DUBLIN 15, IRELAND	
TITLE TYPICAL ETHERNET VISION SYSTEM LAYOUT & WIRING, IN-FLOW STYLE SYSTEMS, CANTY U.	
SIZE C	REVISION 1
FILE NAME C11084	
SCALE NTS	SHEET 1 OF 1