

SCALE 1 / 2

TERMINAL BLOCK WIRING	
TERMINAL BLOCK POSITION	FUNCTION
1	LIVE INPUT (FUSED)
2	RESERVED
3	RESERVED
4	NEUTRAL INPUT
5	RESERVED
6	EARTH INPUT
7	EARTH OUTPUT CAMERA
8	EARTH OUTPUT LIGHT

ALL REMAINING TERMINAL BLOCK POSITIONS ARE PREWIRED BY CANTY. NO AVAILABLE CONNECTIONS.

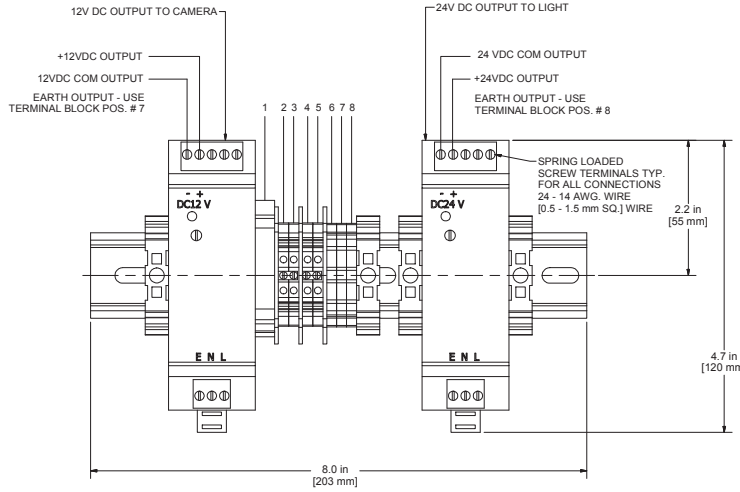

TOP
SCALE 1 : 1

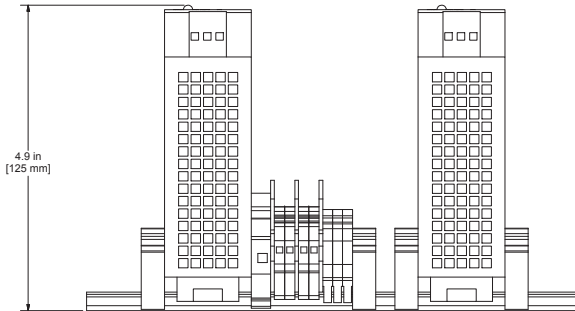

FRONT
SCALE 1 : 1

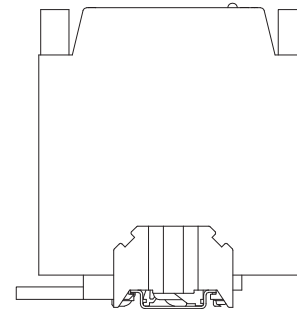

SPECIFICATIONS	
P/N	VC11285-500
MODEL	POWER SUPPLY, DIN RAIL, REGULATED 12V DC/24VDC
INPUT SPECIFICATIONS	100-240V AC, 50/60 Hz, 1A
OUTPUT SPECIFICATIONS	12 VDC, 1A MAX. (CAMERA), 24VDC 3.75A MAX. (LIGHT)
FEATURES	
- 35 mm DIN RAIL MOUNT. CUSTOMER TO PROVIDE ENCLOSURE AS REQUIRED.	
- MAX. RECOMMENDED OUTPUT CABLE DISTANCE FOR ALL CONNECTIONS IS 100 FT. [30.5 m] WITH 16 AWG / 1.5mm ² MIN. SHIELDED WIRE.	

- NOTES:**
1. CUSTOMER MUST MOUNT ON A PROPERLY SUPPORTED VERTICAL STRUCTURE IN THE ORIENTATION SHOWN.
 2. APPROXIMATE WEIGHT 2.5 LBS [1.1 KGS].
 3. ALL INFORMATION IS SUBJECT TO CHANGE WITHOUT NOTICE.

<p>NOTICE</p> <p>THIS DRAWING IS THE PROPERTY OF J.M. CANTY AND MUST BE RETURNED WITHOUT REPRODUCTION OR DUPLICATION, AT ANY TIME, UPON REQUEST, BUT IN ANY EVENT AS SOON AS IT HAS SERVED THE PURPOSE FOR WHICH IT WAS FURNISHED, WHILE IN THE POSSESSION OF THE RECIPIENT, IT MUST BE PROPERLY SAFEGUARDED AGAINST DISCLOSURE TO ANYONE EXCEPT THOSE EMPLOYEES WHO REQUIRE IT FOR WORK ON JOB. THE RECIPIENT MUST KEEP CONFIDENTIAL AND REQUIRE HIS (HER) EMPLOYEES TO KEEP CONFIDENTIAL THE INFORMATION CONTAINED HERE ON.</p>	<p>IMPORTANT FOR THE REQUIRED MANUFACTURING SPECIFICATIONS SEE DOCUMENT #A4955</p>	<p>DRAWN BY JD</p> <p>DATE 11/16/2009</p>	<p>J.M. CANTY INC. 6100 DONNER RD. BUFFALO, N.Y. 14294 U.S.A.</p>	<p>CANTY</p> <p>WWW.JMCANTY.COM</p>	<p>J.M. CANTY INTL. LTD. BALLYCOOLIN BUS. PK. BLANCHARDSTOWN DUBLIN 15, IRELAND</p>	
	<p>NOTE: FAILURE TO RECEIVE DOCUMENT DOES NOT WAIVE VENDOR RESPONSIBILITY</p>	<p>APPROVAL JD</p> <p>DATE 11/17/2009</p>	<p>ENGINEERING ANALYSIS CURRENT</p>	<p>TITLE POWER SUPPLY SUB. SPEC., VC11285-500 PSU, DIN RAIL MT., REGULATED 12V DC/24VDC OUTPUT</p>	<p>FILE NAME TC11285-540</p>	<p>SHEET 1 OF 1</p>
	<p>DATE 11/16/2009</p>	<p>DATE 11/17/2009</p>	<p>DATE</p>	<p>SIZE/REVISION D 1</p>	<p>SCALE AS NOTED</p>	<p>1</p>
	<p>DATE</p>	<p>DATE</p>	<p>DATE</p>	<p>DATE</p>	<p>DATE</p>	<p>DATE</p>